

DIN912

内六角圆柱头螺钉DIN912

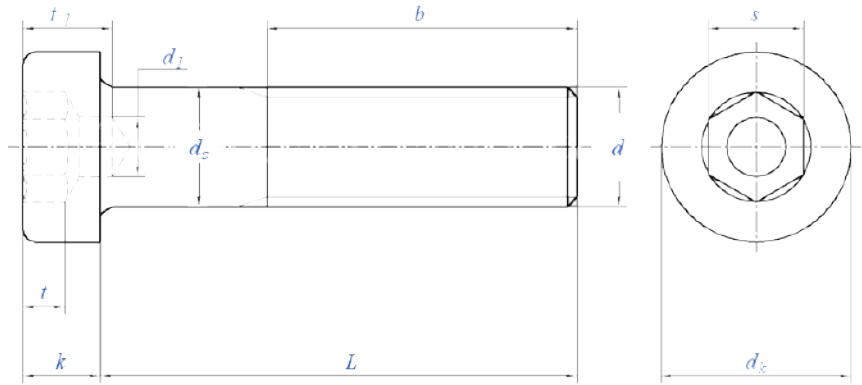

Thread Size	P			dk			da	ds		e	k		s			t	w	weight kg	thread length b
	Coarse thread	Fine thread-1	Fine thread-2	round head max	knurled head max	min		max	max		min	min	max	min	basic				
M1.4	0.3	-	-	2.6	2.74	2.46	1.8	1.4	1.26	1.5	1.4	1.26	1.3	1.32	1.36	0.6	0.5	-	-
M1.6	0.35	-	-	3	3.14	2.86	2	1.6	1.46	1.73	1.6	1.46	1.5	1.52	1.56	0.7	0.55	-	-
M2	0.4	-	-	3.8	3.98	3.62	2.6	2	1.86	1.73	2	1.86	1.5	1.52	1.56	1	0.55	-	-
M2.5	0.45	-	-	4.5	4.68	4.32	3.1	2.5	2.36	2.3	2.5	2.36	2	2.02	2.06	1.1	0.85	-	-
M3	0.5	-	-	5.5	5.68	5.32	3.6	3	2.86	2.87	3	2.86	2.5	2.52	2.58	1.3	1.15	-	-
M4	0.7	-	-	7	7.22	6.78	4.7	4	3.82	3.44	4	3.82	3	3.02	3.08	2	1.4	-	-
M5	0.8	-	-	8.5	8.72	8.28	5.7	5	4.82	4.58	5	4.82	4	4.02	4.095	2.5	1.9	-	-
M6	1	-	-	10	10.22	9.78	6.8	6	5.82	5.72	6	5.7	5	5.02	5.14	3	2.3	-	-
M8	1.25	1	-	13	13.27	12.73	9.2	8	7.78	6.86	8	7.64	6	6.02	6.14	4	3	-	-
M10	1.5	1.25	1	16	16.27	15.73	11.2	10	9.78	9.15	10	9.64	8	8.025	8.175	5	4	-	-
M12	1.75	1.25	1.5	18	18.27	17.73	13.7	12	11.73	11.43	12	11.57	10	10.03	10.175	6	4.8	-	-
(M14)	2	1.5	-	21	21.33	20.67	15.7	14	13.73	13.72	14	13.57	12	12.03	12.212	7	5.8	-	-
M16	2	1.5	-	24	24.33	23.67	17.7	16	15.73	16	16	15.57	14	14.03	14.212	8	6.8	-	-
(M18)	2.5	1.5	2	27	27.33	26.67	20.2	18	17.73	16	18	15.57	14	14.03	14.212	9	7.8	-	-
M20	2.5	1.5	2	30	30.33	29.67	22.4	20	19.67	19.44	20	19.48	17	17.05	17.23	10	8.6	-	-
(M22)	2.5	1.5	2	33	33.39	32.61	24.4	22	21.67	19.44	22	21.48	17	17.05	17.23	11	9.4	-	-
M24	3	2	-	36	36.39	35.61	26.4	24	23.67	21.73	24	23.48	19	19.07	19.275	12	10.4	-	-
(M27)	3	2	-	40	40.39	39.61	30.4	27	26.67	21.73	27	26.48	19	19.07	19.275	13.5	11.9	-	-
M30	3.5	2	-	45	45.39	44.61	33.4	30	29.67	25.15	30	29.48	22	22.07	22.275	15.5	13.1	-	-
(M33)	3.5	2	-	50	50.39	49.16	36.4	33	32.61	27.43	33	32.38	24	24.07	24.275	18	13.5	-	-
M36	4	3	-	54	54.46	53.54	39.4	36	35.61	30.85	36	35.38	27	27.07	27.275	19	15.3	-	-
M42	4.5	3	-	63	63.46	62.54	45.5	42	41.61	36.57	42	41.38	32	32.08	32.33	24	16.3	-	-
M48	5	3	-	72	72.46	71.54	52.6	48	47.61	41.13	48	47.38	36	36.08	36.33	28	17.5	-	-
M56	5.5	4	-	84	84.54	83.64	63	56	55.54	46.83	56	55.26	41	41.08	41.33	34	19	-	-
M64	6	4	-	96	96.54	95.46	71	64	63.54	52.53	64	63.26	46	46.08	46.33	38	22	-	-
M72	6	4	-	108	108.54	107.5	79	72	71.54	62.81	72	71.26	55	55.1	55.4	43	25	-	-
M80	6	4	-	120	120.54	119.5	87	80	79.54	74.21	80	79.26	65	65.1	65.4	48	27	-	-
M90	6	4	-	135	135.63	134.7	97	90	89.46	85.61	90	89.13	75	75.1	75.4	54	32	-	-
M100	6	4	-	150	150.63	149.4	107	100	99.46	97.04	100	99.13	85	85.12	85.47	60	34	-	-