

DIN439 B

带倒角的六角薄螺母DIN439 B

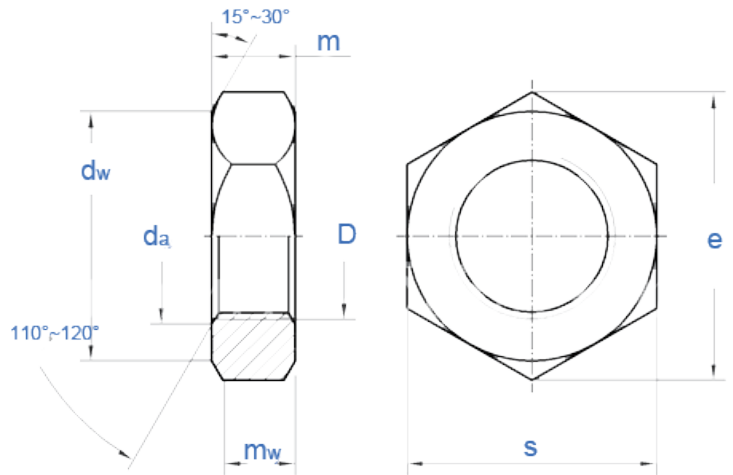

Thread Size	P				da		dw	e	m		mw	s		weight
	Coarse thread	Fine thread-1	Fine thread-2	Fine thread-3	min	max	min	min	max	min	min	max	min	kg
M1.6	0.35	/	/	/	1.6	1.84	2.4	3.48	1	0.75	0.6	3.2	3.08	0.06
(M1.8)	0.35	/	/	/	1.8	2.06	2.7	3.82	1.1	0.85	0.68	3.5	3.38	0.08
M2	0.4	/	/	/	2	2.3	3.1	4.32	1.2	0.95	0.76	4	3.82	0.11
M2.5	0.45	/	/	/	2.5	2.9	4.1	5.45	1.6	1.35	1.08	5	4.82	0.22
M3	0.5	/	/	/	3	3.45	4.6	6.01	1.8	1.55	1.24	5.5	5.32	0.29
(M3.5)	0.6	/	/	/	3.5	4	5.1	6.58	2	1.75	1.4	6	5.82	0.37
M4	0.7	/	/	/	4	4.6	5.9	7.66	2.2	1.95	1.56	7	6.78	0.57
M5	0.8	/	/	/	5	5.75	6.9	8.79	2.7	2.45	1.96	8	7.78	0.83
M6	1	/	/	/	6	6.75	8.9	11.05	3.2	2.9	2.32	10	9.78	1.6
M8	1.25	1	/	/	8	8.75	11.6	14.38	4	3.7	2.96	13	12.73	3.2
M10	1.5	1	1.25	/	10	10.8	15.6	18.9	5	4.7	3.76	17	16.73	7.2
M12	1.75	1.5	1.25	/	12	13	17.4	21.1	6	5.7	4.56	19	18.67	10.4
(M14)	2	1.5	/	/	14	15.1	20.5	24.49	7	6.42	5.14	22	21.67	15.9
M16	2	1.5	/	/	16	17.3	22.5	26.75	8	7.42	5.94	24	23.67	20.5
(M18)	2.5	1.5	2	/	18	19.5	24.9	29.56	9	8.42	6.74	27	26.16	29.6
M20	2.5	2	1.5	/	20	21.6	27.7	32.95	10	9.1	7.28	30	29.16	40.2
(M22)	2.5	1.5	2	/	22	23.8	29.5	35.03	11	9.9	7.92	32	31	48.3
M24	3	2	1.5	/	24	25.9	33.2	39.55	12	10.9	8.72	36	35	69.5
(M27)	3	2	/	1.5	27	29.2	38	45.2	13.5	12.4	9.9	41	40	101
M30	3.5	2	/	1.5	30	32.4	42.7	50.85	15	13.9	11.1	46	45	139
(M33)	3.5	2	/	1.5	33	35.6	46.6	55.37	16.5	15.4	12.3	50	49	183
M36	4	3	2	1.5	36	38.9	51.1	60.79	18	16.9	13.5	55	53.8	244
(M39)	4	3	2	1.5	39	42.1	55.9	66.44	19.5	18.2	14.6	60	58.8	316
M42	4.5	3	2	1.5	42	45.4	60	71.3	21	19.7	15.8	65	63.1	403
(M45)	4.5	3	2	1.5	45	48.6	64.7	76.95	22.5	21.2	17	70	68.1	500
M48	5	3	2	1.5	48	51.8	69.4	82.6	24	22.7	18.2	75	73.1	617
(M52)	5	3	2	1.5	52	56.2	74.2	88.25	26	24.7	19.8	80	78.1	755